

Individual mounting

inline

Manifold mounting

stacking

sub-base non "plug-in"

sub-base with pressure regulators

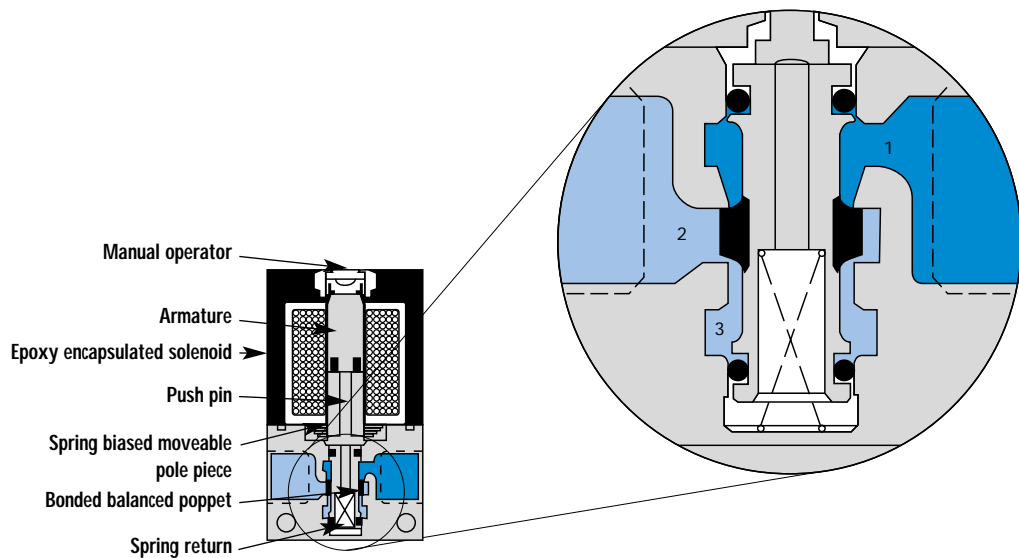

SERIES FEATURES

- Patented MACSOLENOID® for fastest possible response times.
- Bonded balanced poppet for high flow, precise repeatability, and consistent operation.
- Balanced poppet permits versatility in function — may be used as 3-way or 2-way normally open or normally closed and may be used for vacuum, divertor, or selector applications.
- Extremely high cycle rate capability.
- Use on lube or non-lube service.
- Manual overrides as standard.
- Various solenoid enclosures and plug-in connectors.
- Optional surge suppression (M.O.V. or Diode) available.
- Low wattage DC solenoids — down to 1.8 watts.
- Patented MACSOLENOID® — virtually burn-out proof on AC service.

VALVE CONFIGURATIONS AVAILABLE :

The 35 Series is a miniature 3 way or 2 way valve.

This valve provides extremely fast response, long life and high flow in a surprisingly small package.

- Individual, stacking body or manifold base.
- 3 way—Normally Open or Normally Closed.
- 2 way—Normally Open or Normally Closed.
- Optional Normally Closed Only Models.
- Selectors & Divertors.

PIPING CHART FOR INDIVIDUAL MODELS

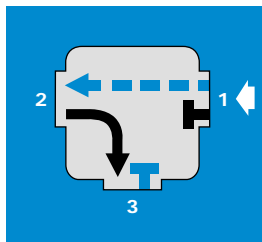

3 Way
Normally Closed

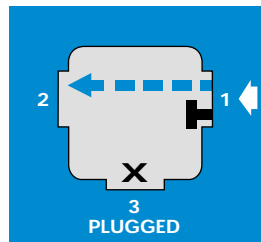

2 Way
Normally Closed

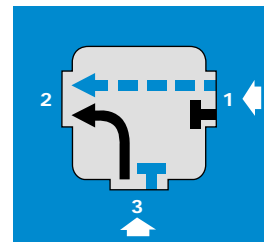

Selector

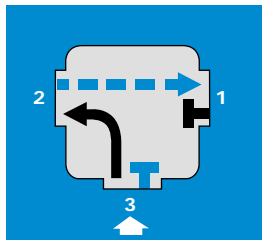

3 Way
Normally Open

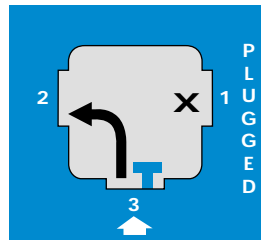

2 Way
Normally Open

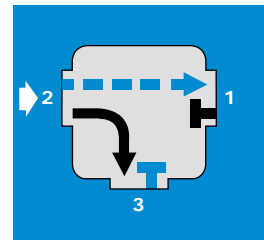

Divertor





Direct solenoid and solenoid pilot operated valves

Function	Port size	Flow (Max)	Individual mounting
3/2 NO-NC, 2/2 NO-NC	1/8"	0.17 C _v	inline

OPERATIONAL BENEFITS

1. Balanced poppet, immune to variations of pressure.
2. Short stroke with high flow.
3. The patented solenoid develops high shifting forces.
4. Powerful return spring.
5. Manual operator standard on all valves.
6. Burn-out proof solenoid on AC service.

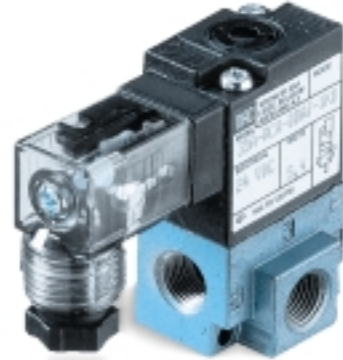

HOW TO ORDER

Port size	Universal valve	NC only valve
1/8" NPTF	35A-AAA-Dxxx-xxx	35A-AAB-Dxxx-xxx

SOLENOID OPERATOR >

D **XX** X- X **XX**

XX	Voltage	X	Wire length	X	Manual operator	XX	Electrical connection
AA	120/60, 110/50	A	18" (Flying leads)	1	Non-locking	KA	Square connector
AB	240/60, 220/50	J	Connector	2	Locking	KD	Square connector with light
AC	24/60, 24/50					JB	Rectangular connector
FB	24 VDC (1.8 W)					JD	Rectangular connector with light
DA	24 VDC (5.4 W)					BA	Flying leads
DF	24 VDC (12.7 W)						

OPTIONS

35A-CAX-Dxxx-xxx
 - with (2) # 10-32 ports in backside of valve

TECHNICAL DATA

Fluid :	Compressed air, vacuum, inert gases		
Pressure range :	Vacuum to 120 PSI		
Lubrication :	Not required, if used select a medium aniline point lubricant (between 180°F and 210°F)		
Filtration :	40 μ		
Temperature range :	0°F to 120°F (-18°C to 50°C)		
Flow (at 6 bar, ΔP=1bar) :	1.8 W : 0.08 C _v , 5.4 W : 0.15 C _v		
Leak rate :	50 cm ³ /min		
Coil :	General purpose class A, continuous duty, encapsulated		
Voltage range :	-15% to +10% of nominal voltage		
Protection :	Consult factory		
Power :	~ Inrush : 10.9 VA Holding : 7.7 VA = 1.8 to 12.7 W		
Response times :	24 VDC (5.4 W)	Energize : 6 ms	De-energize : 2 ms
	120/60	Energize : 3-8 ms	De-energize : 2-7 ms

Spare parts :

- Solenoid operator (power ≥ 5.4 W) : DXXX-XXX, including mounting screws 35013.
- Seal (between solenoid and valve body) : 16402.

Options :

- BSPP threads. • High flow up to 0.25 C_v, according to wattage and high flow mod.

DIMENSIONS

Dimensions shown are metric (mm)

